

CertainTeed Ceilings Ecophon® Focus™ D Accessibility Guide

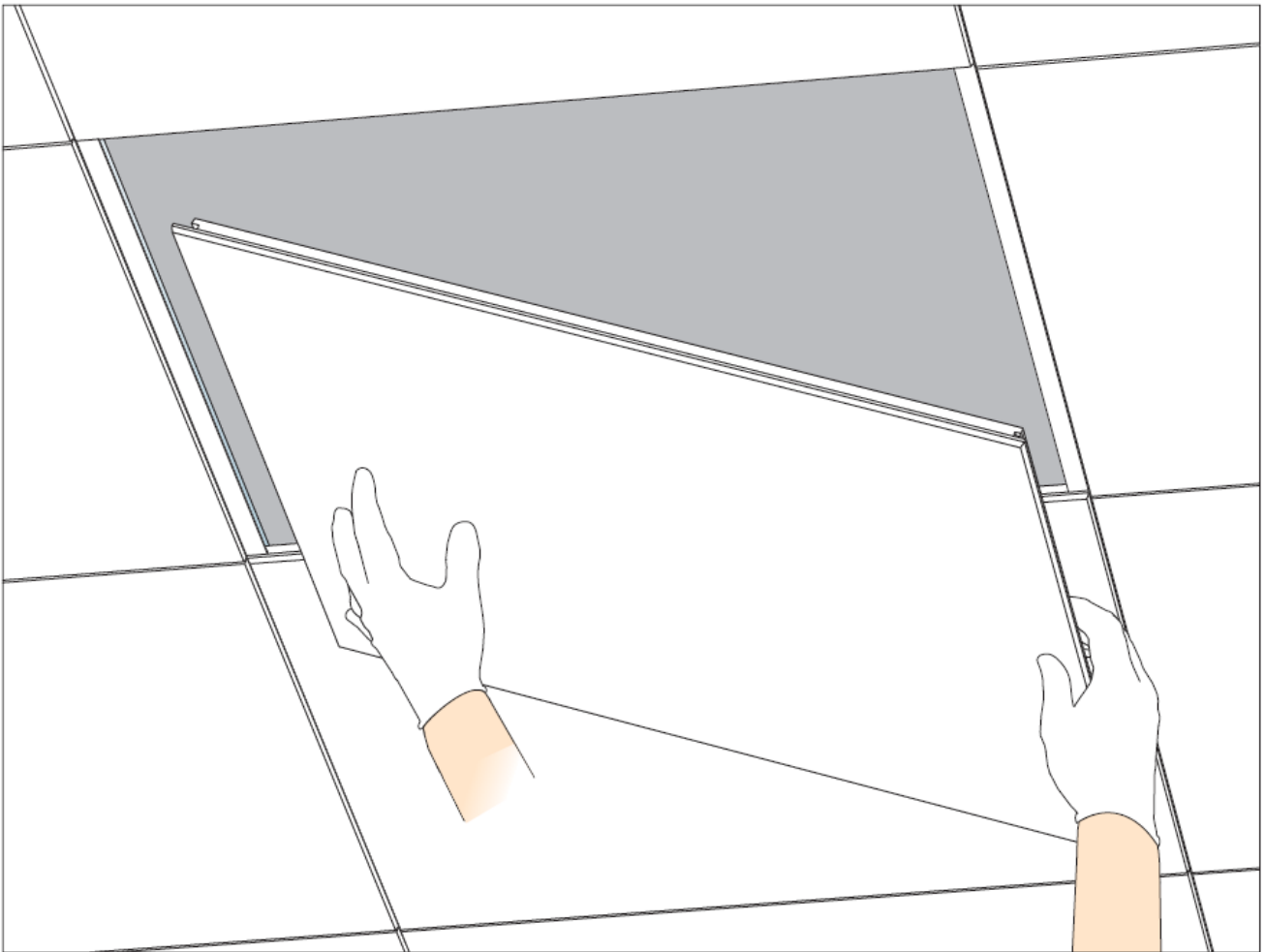

To remove CertainTeed Ceilings Ecophon Focus D panels, use white cotton gloves and follow the directions. Larger panels may require two people.

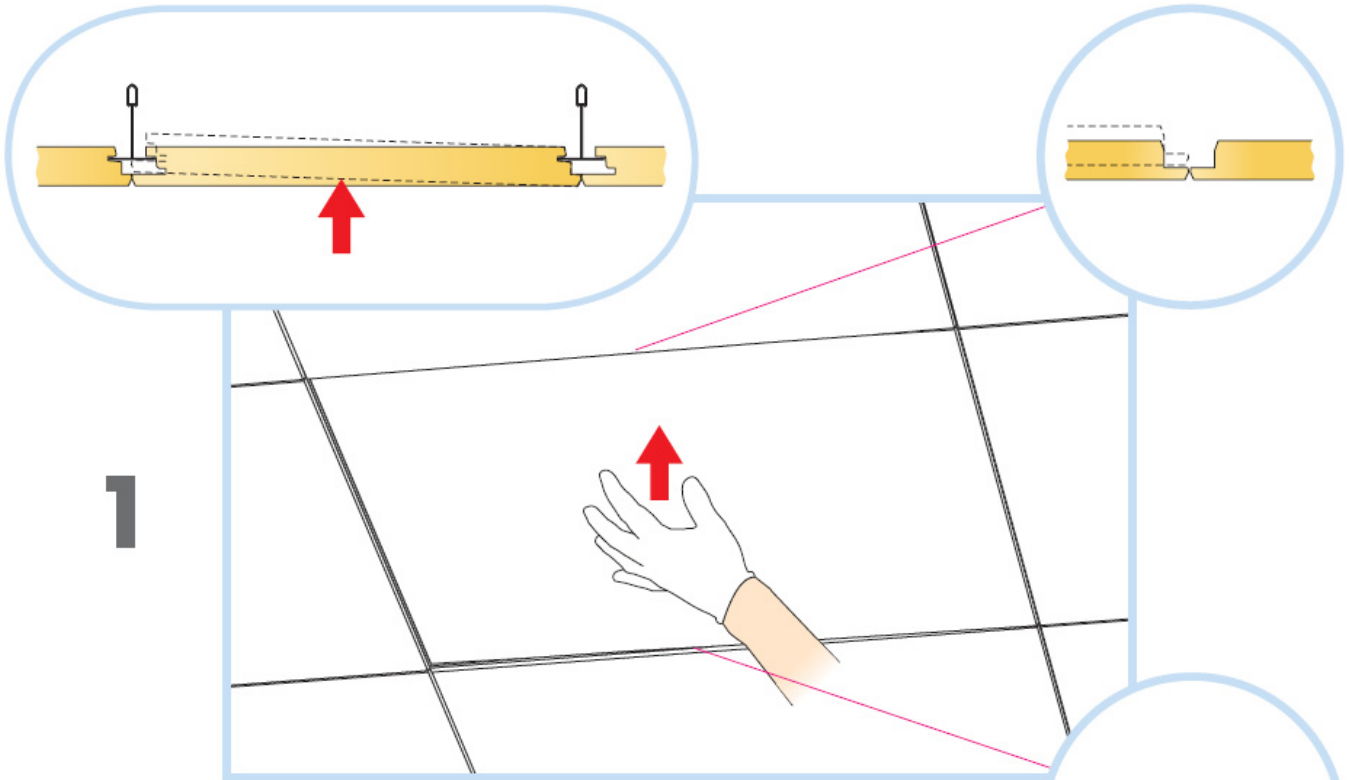

1

Place your hand on the center of the panel and gently push up to disengage the panel. Note: One edge will disengage higher than the other 3 sides.

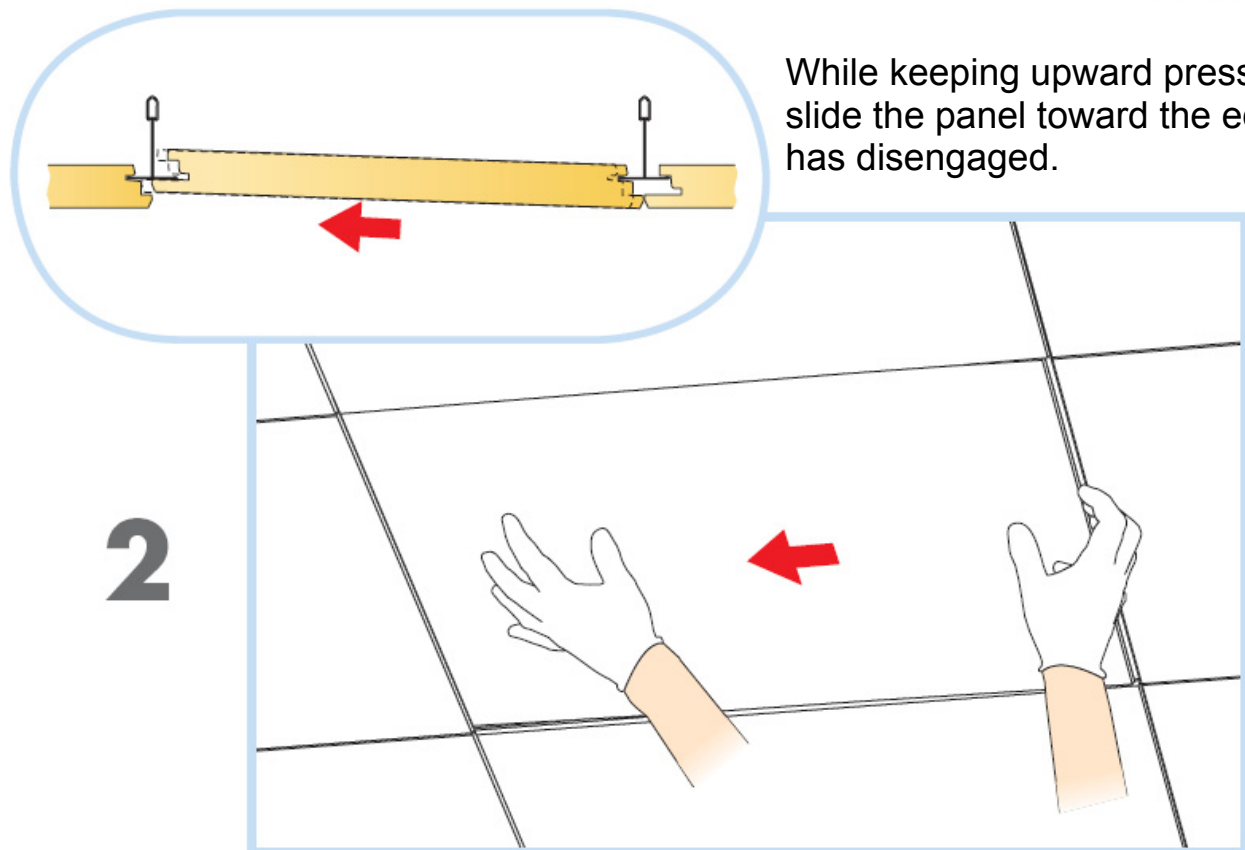

2

While keeping upward pressure, gently slide the panel toward the edge that has disengaged.

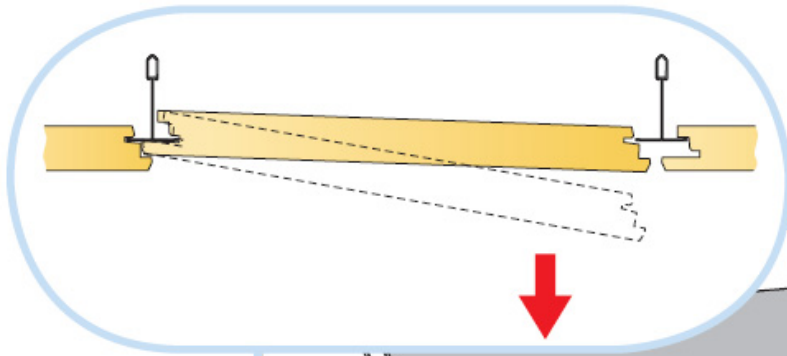

The panel will disengage as illustrated.

3

